



**EH5864**

Prem-I-Air 20" (50cm) High Velocity Stand Fan  
with 360° Head



## **User Manual**

Please Retain for Future Reference

### **IMPORTANT**

**Installer and Users please note:**

These instructions should be read carefully and left with the user of the product for future reference.

## BEFORE USE

You must inspect the appliance including its cable and plug for any signs of damage. If the product is damaged, DO NOT use it, and contact your supplier immediately.

## INTENDED USE

Designed to be used as a domestic fan

## PRODUCT SAFETY

- For indoor use only
- Only use this product on a flat stable surface
- Do not leave this product unattended when in use
- Leave at least 50cm gap around the product to allow for airflow
- Disconnect from the mains supply when not in use.
- Do not use in areas of high dust or particle concentration: Risk of explosion
- This appliance can be used by children aged from 8 years and above and persons with reduced physical, sensory or mental capabilities or lack of experience and knowledge if they have been given supervision or instruction concerning use of the appliance in a safe way and understand the hazards involved.
- Children shall not play with the appliance.
- Cleaning and user maintenance shall not be made by children without supervision.
- Do not use in close proximity to gas appliances
- Do not use unless correctly installed.
- Do not cover when in use.
- Do not place the mains lead beneath a carpet or rug.
- Do not use the appliance in locations where paint, petrol or other flammable liquids are used or stored.
- Not suitable for use in boats, caravans or other similar areas.
- Do not insert any object into the appliance through the grilles. This may damage the appliance or result in overheating or electric shock.
- Do not use this appliance in the immediate surroundings of a bath, a shower or a swimming pool.
- The appliance is fitted with an overload cut-out which will operate if the motor overheats or is stalled. If this happens, disconnect from the mains supply immediately, and allow the motor to cool down.

## IDENTIFICATION OF PARTS

1. Front Grille
2. Fan Blade
3. Blade Securing Screw
4. Securing Screw
4. Back Grille
5. Fan Motor
6. Speed Control Box
7. Power Cord
8. Locking Nut
9. Plastic Spacer
10. Locking Screw
11. Supporting Tube
12. Screw
13. Stand Tube
14. Base
15. Weight Block
16. Fixing Plate
17. Base Locking Screw

(see fig. 1)

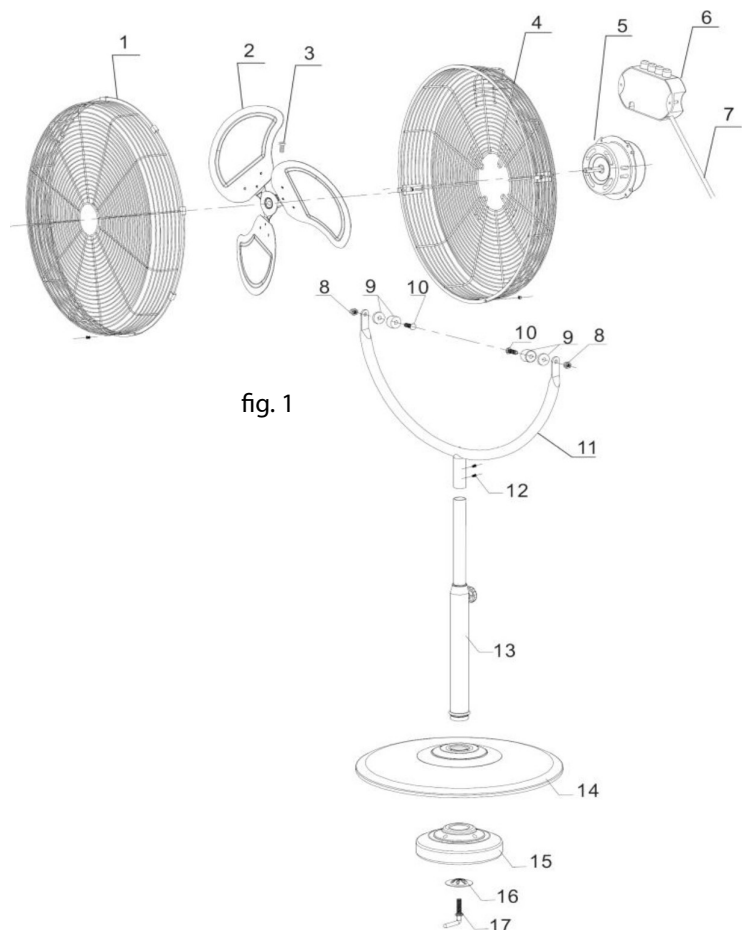

## ASSEMBLY

1. Slide the Supporting Tube over the Stand Tube and tighten using the Securing Screw (see fig. 2)

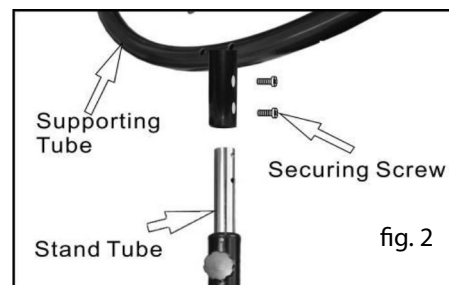

2. Pass the base locking screw up through the fixing plate, weighted block and base and screw securely into the bottom of the stand tube as shown (see fig. 3)

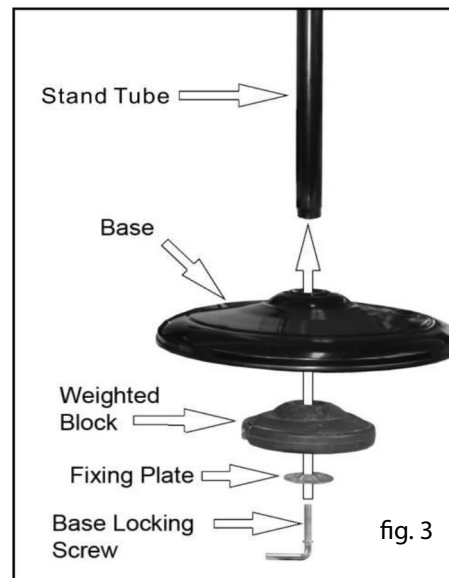

## OPERATION

- Plug the mains lead into a 13 Amp mains socket.
- If connecting via an extension lead, make sure that the lead is rated at 3 Amps or more, and that it is fully unwound. If any other appliances are connected to the same extension lead, make sure that it is rated for the total power of all appliances connected.
- Switch the appliance on at the mains socket.
- Connect the power and press Speed buttons (1, 2, 3). The fan will start to operate to the speed level chosen (see fig. 4)

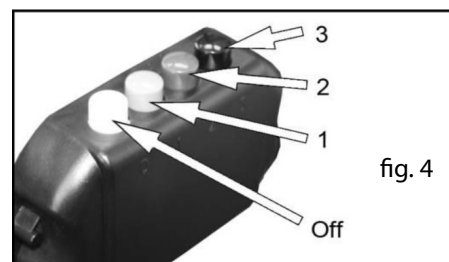

### TILTING THE FAN

- You can adjust the angle of the fan by holding the supporting tube and tilting the fan to the required angle.
- Tighten the nuts on the side of the fan slightly if the fan will not stay in position.

### ADJUSTING THE HEIGHT

- (a) Loosen the height adjustment knob.
- (b) Raise or lower the fan to the required height.
- (c) Tighten the height adjustment knob to lock the fan in the new position (see fig. 5)

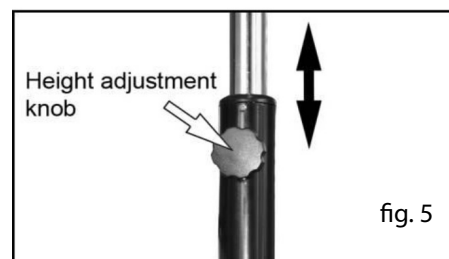

## OPERATING COSTS

At time of going to press, the average cost of electricity is £0.12 per unit (kilowatt-hour). The amount you are being charged will be shown on your electricity bill. At this cost, the appliance will cost 8p per day to run on the “low speed” setting, 10p per day on the “medium speed” setting or 12p per day to run on the “high speed” setting.

## PAT TESTING

When used in an office environment, we recommend that this product should be safety-tested yearly by a qualified electrician (PAT Tested). We recommend that it is PAT tested regularly when used in a domestic environment.

## GENERAL SAFETY REQUIREMENTS

Domestic wiring must be tested periodically by a qualified electrician at least once every 10 years or at every change of occupancy. For office and retail premises, and buildings such as village halls, the wiring must be inspected at least once every 5 years. It is recommended that all building be fitted with smoke alarms (it is mandatory for new buildings).

## DISPOSAL AND RECYCLING

You must not dispose of this appliance with domestic household waste. Most local authorities have specific collection system for appliances and disposal is free of charge to the end-user. When replacing an existing appliance with a similar new appliance your retailer may take the old appliance for disposal.

## MAINTENANCE

Before cleaning, turn the appliance off, and disconnect from the mains supply. The appliance may then be cleaned using a damp cloth with a drop of washing-up liquid to remove any dust or dirt from the case. Do not use stronger detergents or solvents as these may damage the paint finish.

Using a dry 1" (25mm) paint-brush, remove any dust from the grilles.

If the mains lead is damaged, it must be replaced by the manufacturer or an authorised service centre.

If the mains plug needs to be replaced, proceed as follows:

- Connect the brown wire to the terminal labelled “L”.
- Connect the blue wire to the terminal labelled “N”.
- Make sure that the cord-grip is positioned correctly (over the outer sheath of the cable) and it is fully tightened.
- If the plug is fitted with a 13A or 5A fuse, replace it by a 3A fuse.

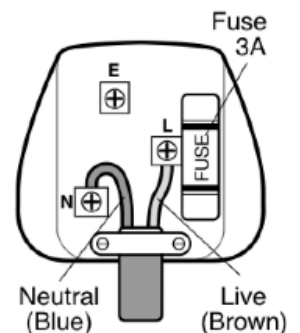

## TECHNICAL SPECIFICATION

Model.....	EH5864
Power Supply.....	230V~
Frequency.....	50Hz
Power.....	100W
Speed Settings.....	3
Service Value.....	1,29 (m <sup>3</sup> /min)/W

## ENVIRONMENTAL RESPONSIBILITIES



Meaning of crossed –out wheeled dustbin:

Do not dispose of electrical appliances as unsorted municipal waste, use separate collection facilities.

Contact your local council for information regarding the collection systems available.

If electrical appliances are disposed of in landfills or dumps, hazardous substances can leak into the groundwater and get into the food chain damaging your health and well-being.

When replacing old appliances with new ones, the retailer is legally obligated to take back your old appliance for disposal free of charge

## SERVICE WARRANTY

Prem-i-Air guarantees the product free from defects in materials and workmanship for a period of twelve months.

Should this appliance be operated under conditions other than those recommended, at voltages other than the voltage indicated on the appliance, or any attempts made to service or modify the appliance, then the warranty will be rendered void. The product you buy may sometimes differ slightly from illustrations. This warranty is in addition to, and does not affect, your statutory rights.

Our guarantee is administered by our retailers.

If your product arrives damaged, you must contact the retailer from whom you bought it. The retailer's contact details will be on the invoice that arrived with the product, or on the e-mail you received when you placed the order. Do not contact Prem-i-air, only your retailer can arrange a replacement.

If your product fails within the guarantee period, firstly read the "fault finding" section of this manual, because temperature and weather conditions can affect the performance of certain products. If the product needs to be repaired or replaced, you must contact the retailer from whom you bought it.

The retailer's contact details will be on the invoice that arrived with the product, or on the email you received when you placed the order.

If you have just received your product and require technical help in using it, please call our Help Desk on (0845) 459 4816

If you have any other technical queries about the product, please call our Help Desk on (0845) 459 4816.



**Name:** Prem-i-Air Appliances Ltd.

**Address:** Lancots Lane, Sutton Oak, St. Helens, WA9 3EX

**Tel:** 01744 745 030 | **E-mail:** sales@prem-i-air.co.uk

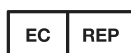

**Name:** Aidapt B.V.

**Address:** Algolweg 22, Amersfoort, 3821BH, NL

**Tel:** +31 0332779210 | **E-mail:** nederland@aidapt.eu