

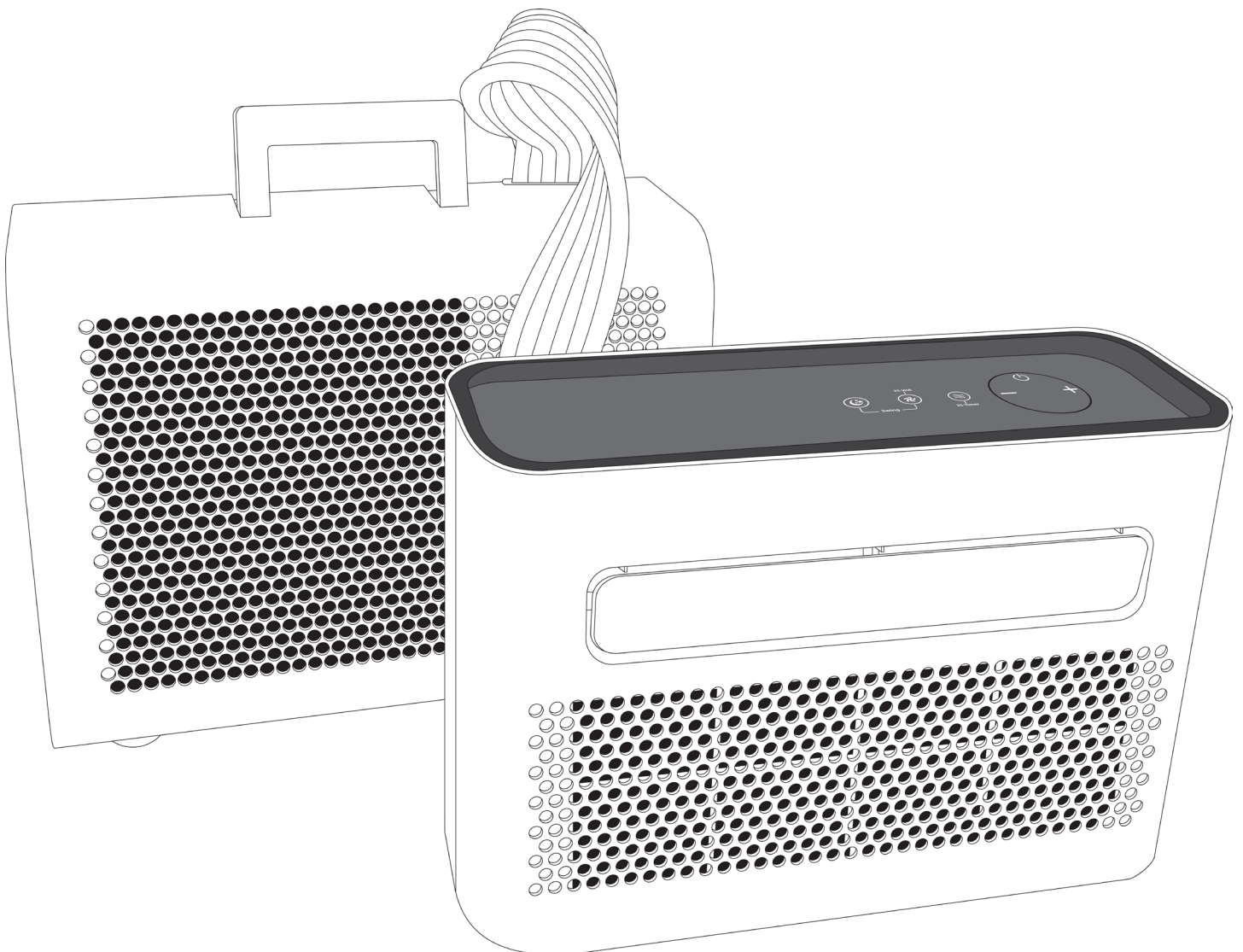

EH1962

5000 BTU Mobile Split Air Conditioner with App Control



User Manual

Please Retain for Future Reference

INTENDED USE

For use only as a domestic personal portable cooling product. This appliance is intended for cooling indoor spaces in domestic environments, in accordance with the instructions in this manual. Any use other than the intended purpose, or installation/operation in conditions outside the specified ambient range, may result in injury, damage, or voiding of the warranty.

INSTRUCTIONS

This manual forms part of the product and should be kept with the unit at all times. Should the unit be sold or moved on then the manual must be included. Please read these instructions carefully before use. This product and its mains lead must be checked before use for any signs of damage. If any is detected then do not use and contact your supplier.

IMPORTANT!

AIR CONDITIONERS MUST ALWAYS BE STORED AND TRANSPORTED UPRIGHT, OTHERWISE IRREPARABLE DAMAGE MAY BE CAUSED TO THE COMPRESSOR; WAIT AT LEAST 24 BEFORE USING

SAFETY

- This product is not intended for use by children under 8 years of age, or by persons with reduced physical, sensory, or mental capabilities, or by those lacking the experience and knowledge necessary to operate it safely, unless they have been given supervision or instruction concerning the safe use of the product by a person responsible for their safety. Children should be supervised to ensure that they do not play with or misuse the product. Improper use may result in injury or damage. The supervising person should ensure that the user understands all relevant safety instructions, operational limitations, and potential hazards before use. This product should be used only in accordance with the safety guidelines and instructions contained in this manual and in compliance with all applicable local laws and regulations.
- For indoor use only.
- Do not use in bathrooms, swimming pools, shower rooms or other such locations
- Do not place the mains lead beneath a carpet or rug.
- Do not use this appliance in locations where paint, petrol or other flammable liquids are used or stored.
- Please ensure the appliance is switched off and unplugged when not in use.
- Do not use the appliance for anything other than its intended use.
- Do not insert any object into the appliance through the grilles. This may damage the product or result in overheating or electric shock.
- Periodically check this product and its mains lead for any signs of damage. If any damage is detected stop using it immediately and consult your supplier.
- The external unit must be securely fixed to a suitable structure by a competent person. A site survey should be carried out beforehand to confirm that the surface is suitable for mounting this product
- Do not leave this product unattended when in use.
- There are no user-serviceable parts inside this product other than the air filter and removal of water from the tank. All maintenance must be carried out by a qualified F-gas engineer. A service manual is available on request
- Do not move or knock this product while in use.
- Do not obstruct the air intakes or exhaust vents
- **Upright use only.** This product must be used and stored upright. Using or storing it otherwise may allow water to reach the electronics, posing **fire and electric shock risks**
- Window suitability. The outdoor window-mount unit fits most windows; **confirm your window is suitable** before installation.
- **Drain before storage.** The indoor unit must be drained and allowed to **dry out** before storage. If stored with water inside—especially if not upright—there is a **fire/electric shock risk**
- This unit is **not intended for permanent installation**
- Do Not Cover or place heavy objects on this unit
- Do not use in areas with high concentrations of dust or fibre particles.
- This product is designed for a 230V AC, 50Hz power supply. Connecting to an incorrect power supply can cause electrical shock or fire.
- Maintain a minimum clearance of 50cm around all sides for adequate airflow.
- This is an electrically powered device. Do not immerse in water or allow water to enter the unit.
- Avoid placing the unit near heat sources such as radiators, ovens, or direct sunlight.
- Care should be taken when fitting this product
- Store this unit in an upright position in a cool dry place when not in use
- Do not Modify this unit in anyway
- Do not use this product with an extension lead, multi-socket adapter, or by sharing the power output from a 13 A socket. Connect the product directly to a suitable mains outlet. Using extension devices or shared outlets may result in overheating, risk of electric shock, or fire hazard
- Maintain a minimum clearance of 2m around the product, ensuring it is kept away from curtains, furniture, paper, and other flammable or heat-sensitive materials. Failure to maintain adequate clearance may result in risk of fire

SAFETY (CONTINUED)

- Do not pull the hose directly or allow it to come into contact with sharp objects. If the hose becomes damaged, stop using the product immediately and contact an authorised dealer or service centre for repair
- Do not use the appliance in heavy rain, snow, or very windy conditions. In severe weather, bring the outdoor unit indoors
- Do not allow children or animals to play with or damage this product, particularly the connecting cord between the two units.
- This appliance contains R290 refrigerant gas, which is flammable. Handle and maintain the unit in accordance with the safety instructions in this manual
- Dust filters should be cleaned once a month and before use at the start of the season
- This unit must only be used and stored in a well-ventilated room of over 4m³
- Only use on a flat stable surface
- Keep away from any source of ignition or naked flame

PARTS LIST

| Part | Qty. |
|-------------------------------|------|
| Inner unit | 1 |
| Outside unit | 1 |
| Drain hose | 1 |
| Protection sleeve | 1 |
| Outside Bracket | 2 |
| Inner Bracket | 2 |
| Shock resistant rubber blocks | 2 |
| Hand screws | 2 |
| M6 Screws and gasket | 12 |

IDENTIFICATION OF PARTS

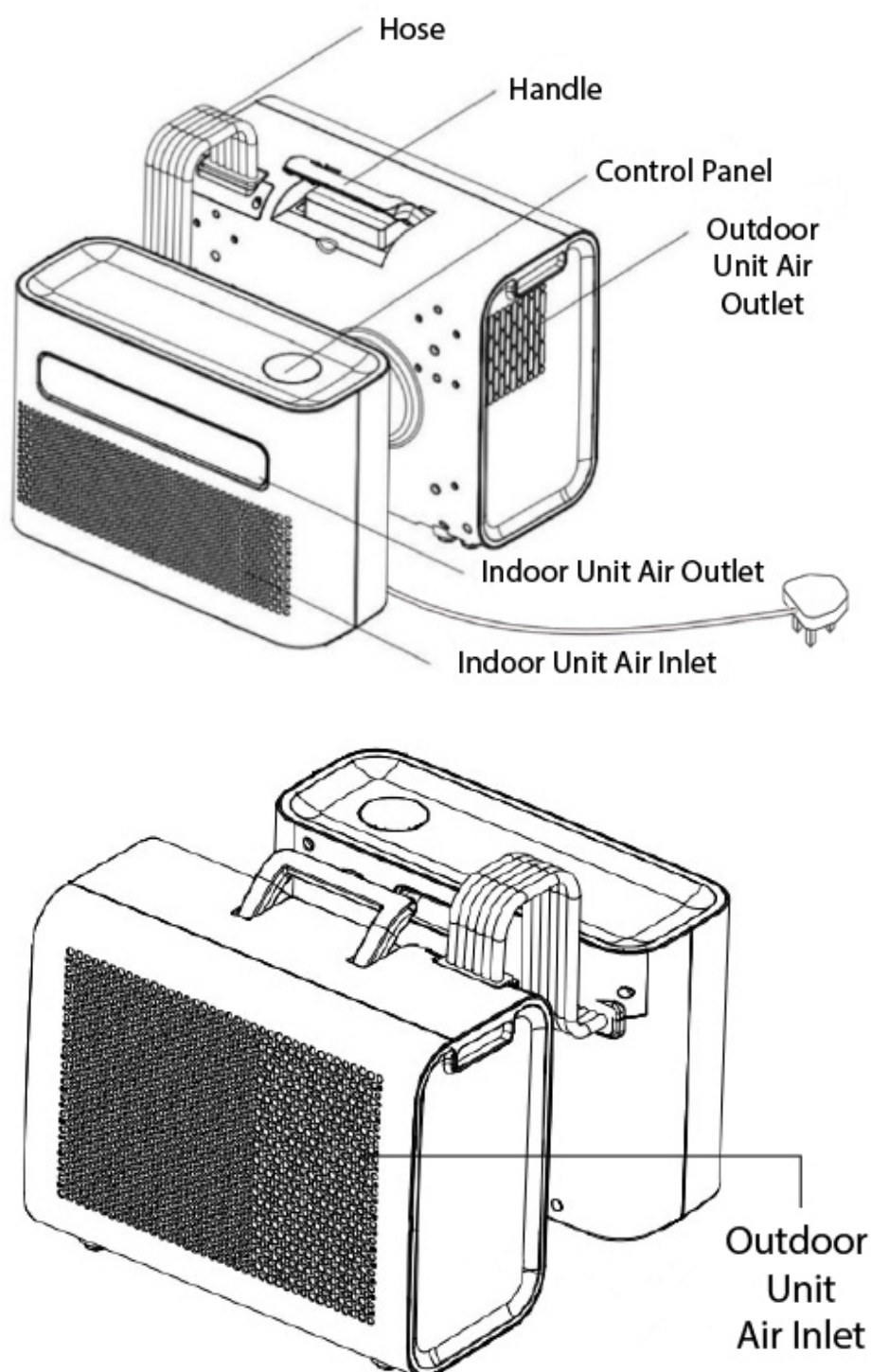

INCLUDED ACCESSORIES

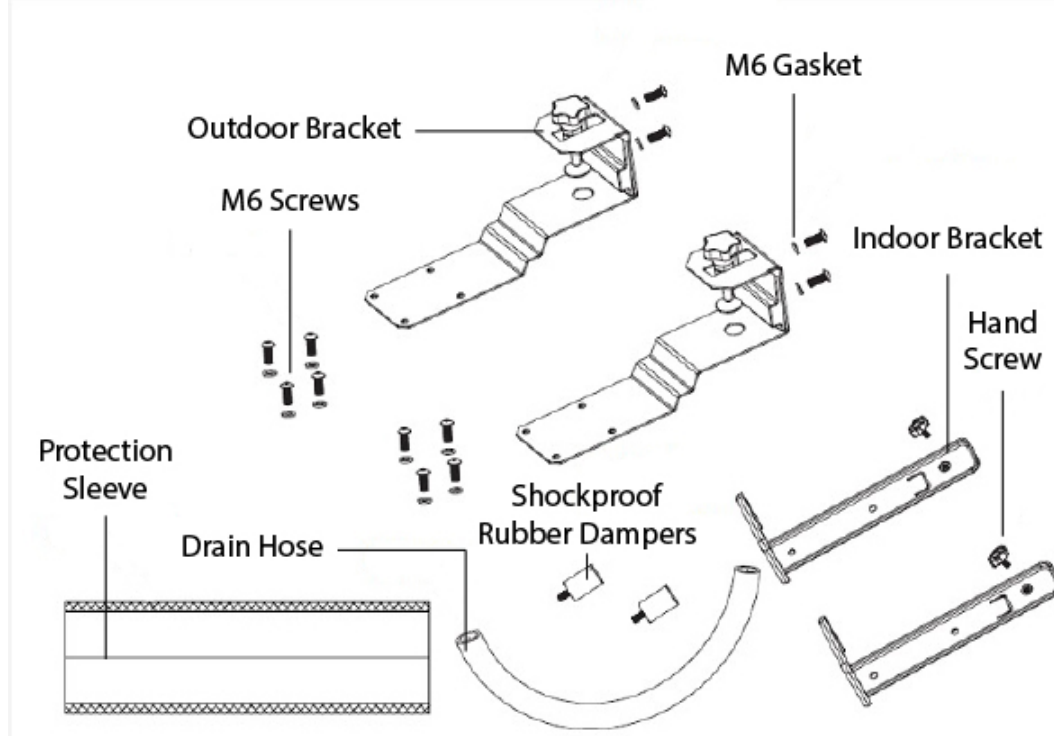

OPERATION OF CONTROL PANEL



1. Power

Press this key to turn the device on and off.

When the air conditioner is switched on, the temperature is set to 22°C by default. The temperature sensor measures the ambient temperature and if exceeds 22°C, the outdoor unit starts to work to bring the temperature down. If the ambient temperature already below 22°C, then the outdoor unit does not start.

2. Mode

Press this key to select cooling, fan, dehumidification modes;

In standby/turned on mode, by pressing this key for 3 seconds to set timing on/off.

3. Temperature / time adjustment

In cooling mode, press the key to increase or decrease the temperature, the setting temperature adjustable from 16~30°C;

In timer mode, press the key to adjust time to turn on/turn off the machine.

Press Up/Down key at the same time to transfer between °C and °F.

4. Fan speed

Press the key to choose low/high fan speed.

5. Sleep mode

Press the key to enter or quit sleep mode. After 20 seconds, all lights and the digital display turn off and the air conditioner goes to sleep. The indoor unit fan continues to run at low fan speed.

OPERATION OF CONTROL PANEL (CONTINUED)

6. Display window

Check temperature and time from this window.

7. Swing

Press fan speed and sleep mode key at the same time to turn on/off swing function.

INSTALLATION OF THE AIR CONDITIONER

1. Unpack the machine and accessories and check that the hose between the indoor and outdoor unit is properly connected. Also check whether the condensation drain has a rubber cover. Finally, check whether the accessories are complete.

2.1. Assemble the brackets as shown in fig. 1. Connect the outer bracket to the support block and the inner bracket by tightening the M6 screws. This is how you form the carrying handle.

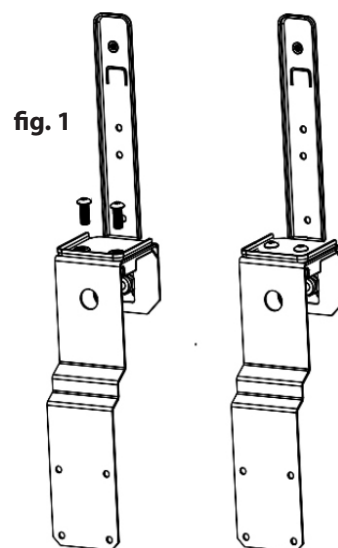

2.2. Place the shockproof rubber dampers on the back of the outdoor unit (see fig.2)

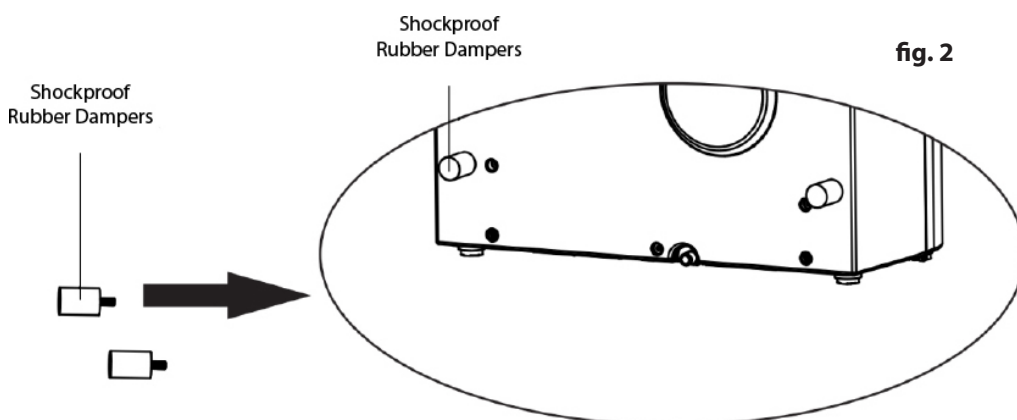

2.3. Attach the brackets as shown in fig. 3. Install the indoor and outdoor units on the bracket to fix the two parts. To secure the units to the bracket, tighten the M6 screws in the appropriate holes.

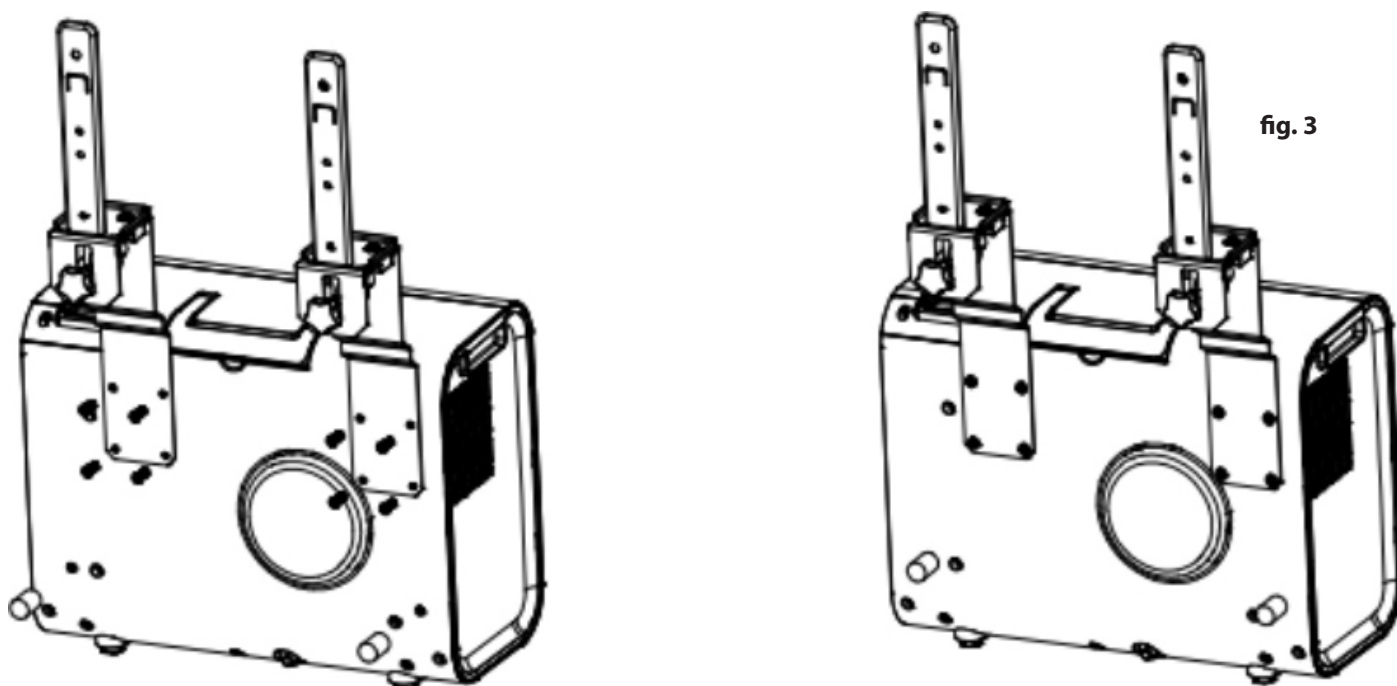

INSTALLATION OF THE AIR CONDITIONER (CONTINUED)

2.4. Install the indoor unit on the bracket and tighten the bracket properly. Next, wrap the protection sleeve on the hose between the outdoor and indoor unit (see fig. 4)

fig. 4

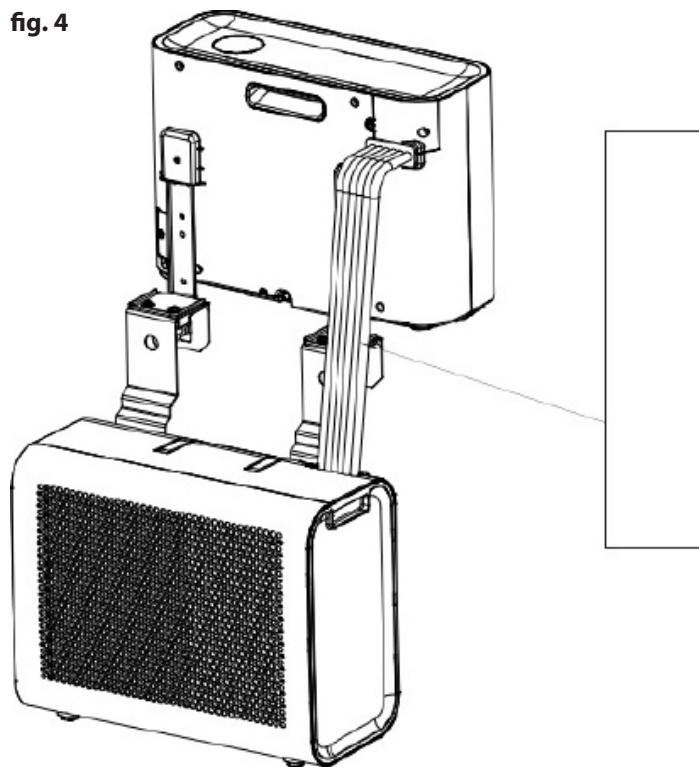

2.5. Install the complete unit in the caravan window and tighten the bracket properly (see fig. 5)

fig. 5

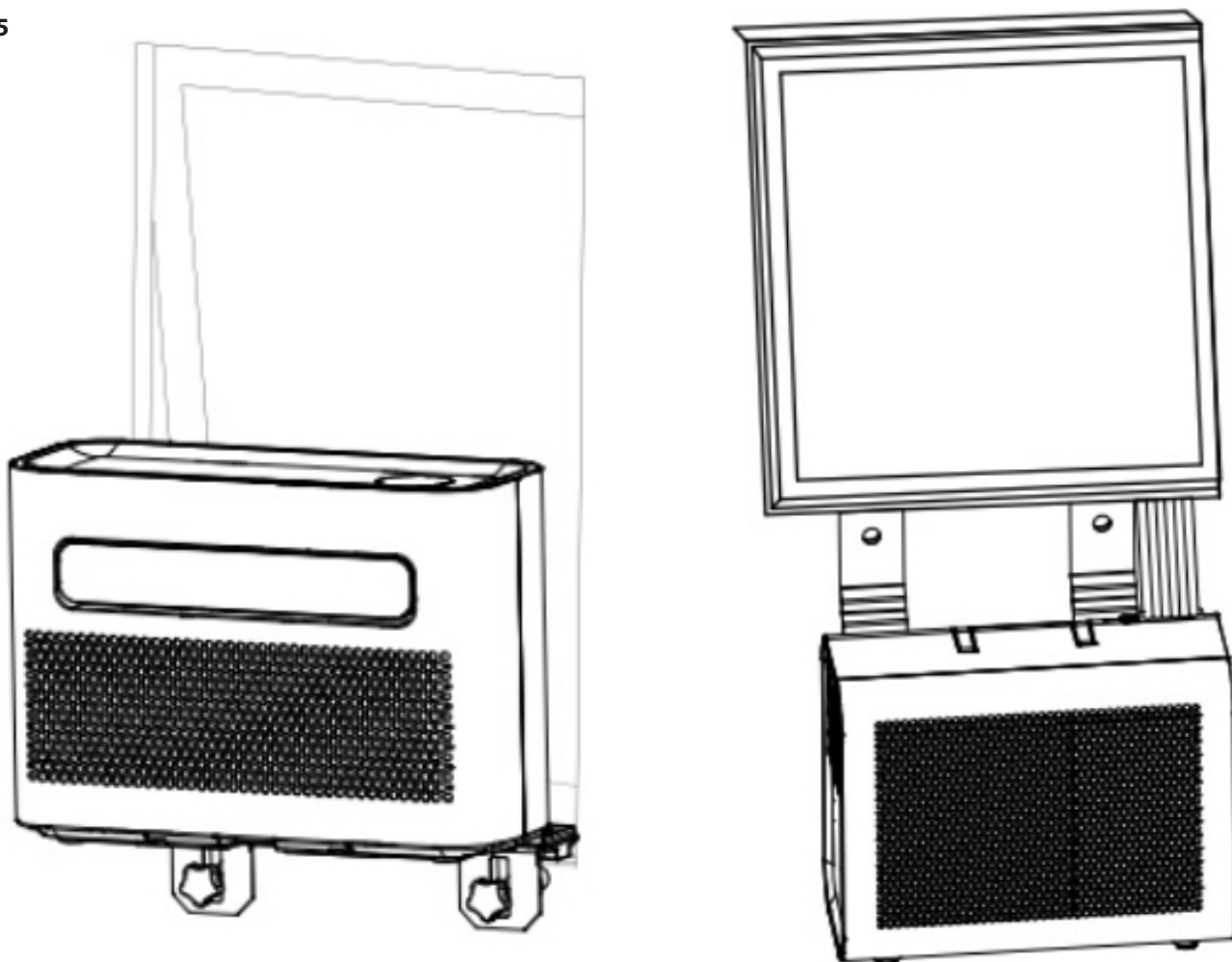

SMART HOME WIFI CONNECTION GUIDE

Install App

Download the "Smart life" app from the Play Store (Android) or App Store (iOS).

Register

If you do not have a Smarter Home account, register or sign in with a verification code sent by SMS.

To register:

1. Tap to enter registration page
2. The system automatically recognizes your country/ area. You can also select your country code manually. Enter your mobile phone number/ email address and tap "Next".
3. If you choose the mobile phone number option, then enter the verification code in the message sent to you by SMS. Set a password as prompted and press "Confirm" to finish your registration



SCAN QR CODE

<

Register

China

Mobile Number/Email

|

Get Verification Code

<

Register

China

Mobile Number/Email

XXXXXXXXXX

Get Verification Code

Add Device Through Network

1. Power conditioner on, when conditioner under standby mode, press the "FAN" button for 3 seconds to enter WiFi-connect mode.
2. Open Smart Home app and tap "+" in the upper right to add a new device through the network.
3. Ensure the device's indicator light rapidly flashes (2 times per second) and tap "Confirm light is rapidly flashing".
4. Select Wi-Fi network (note: network must be 2.4Ghz band) and enter the password .The device will commence the pairing process and connect to the app.
5. After successfully configuring the devices, the AC will be shown on the smart home page. Tap to enter its control page.

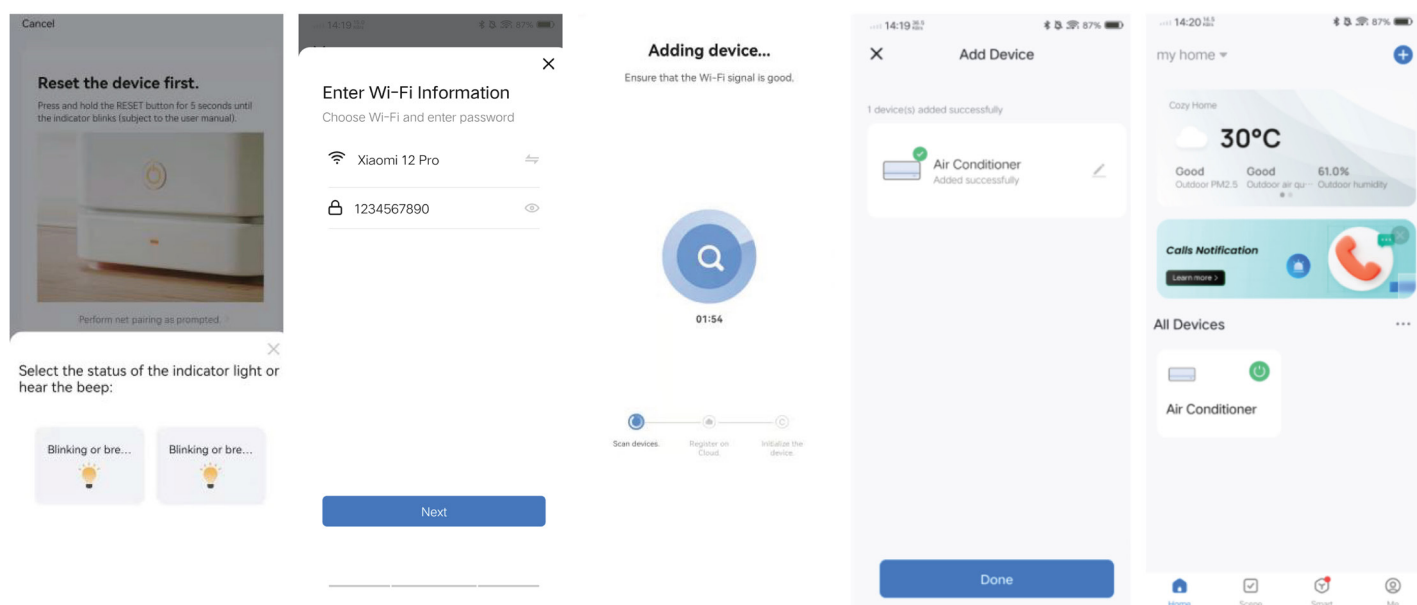

SMART HOME WIFI CONNECTION GUIDE (CONTINUED)

Connecting using Bluetooth

1. Before initiating the connection, make sure the unit is in standby mode.
2. Press the “FAN” button for 3 seconds to enter WiFi-connect mode.
3. Open the Bluetooth of your phone.
4. When the device is powered on and to be connected, the connected Bluetooth device will pop up automatically after opening the App for a moment. Click “Add” button for connection.
5. Enter the Wi-Fi information interface, enter the password and click “Next” to continue the operation. (note: network must be 2.4Ghz band)
6. Enter the device connection interface after the progress bar is finished and the device is successfully connected.
7. Click the “Done” button to enter the operation interface of the device.

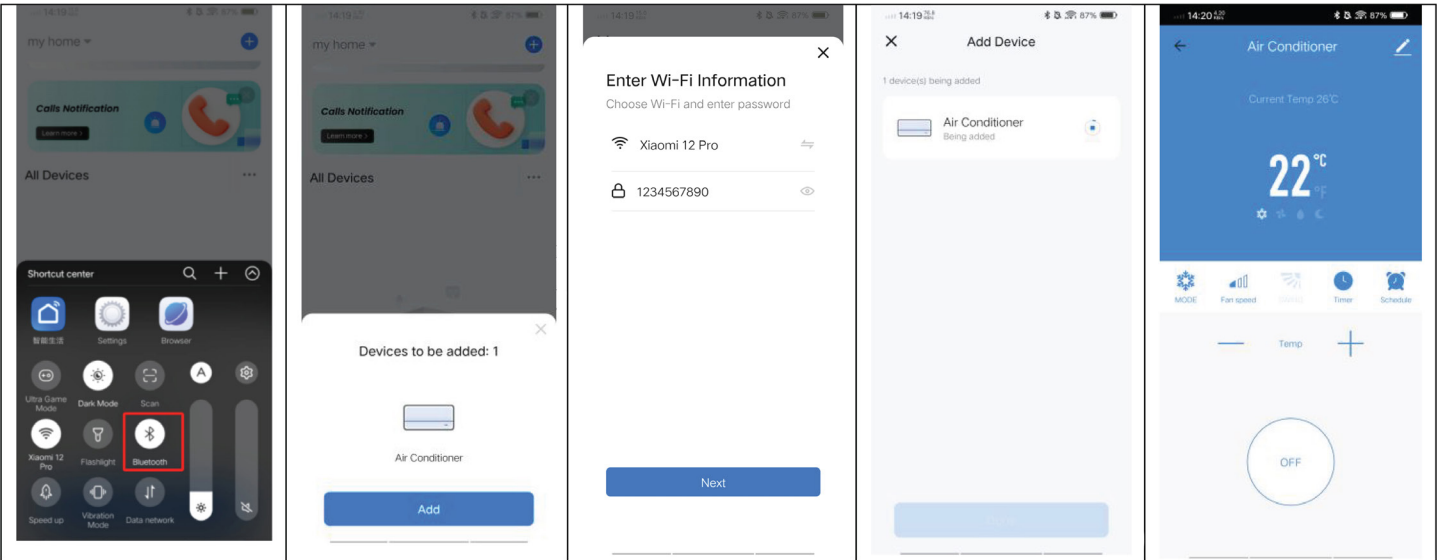

ERROR CODE LIST

If the device does not work or works insufficiently:
Check if an error code is visible in the display, refer to the code table for a solution. If no error code is visible in the display, go through the error table for a possible solution.

| Error code | Cause | Solution |
|------------|---------------------------------|--|
| FL | Water full alarm | Take off rubber stopper and empty the water. |
| E1 | System temperature sensor fault | Replace System temperature sensor |
| E2 | Room temperature sensor fault | Replace room temperature sensor |
| EF | Indoor motor fault | Replace the motor. |
| E4 | Freeze protection | Check that the air outlet is not blocked, keep the air deflector open. |

TROUBLESHOOTING

| Problem | Cause | Solution |
|---|---|---|
| The device does not turn on | No power | Turn power on |
| | Damaged electrical outlet | Turn off the power and check/repair the power outlet |
| | Unknown reason | Contact the dealer |
| | Fuse in plug may have blown | Check fuse in plug |
| Little air displacement or limited cooling effect | The lowest ventilation setting is selected | Select the high ventilation speed mode |
| | The air filter is dirty | Check and clean the filter |
| | The air supply or exhaust of the indoor unit is blocked | Check that the unit is not blocked and remove the obstruction |
| | The air supply or exhaust from the outdoor unit is blocked | Check that the unit is not blocked and remove the obstruction |
| | The ambient temperature is too low or high | The ambient temperature must be between 18 and 40°C |
| | Insufficient voltage from the power supply | Consult an installer or use a different power connection |
| Air displacement only but no cooling effect | The device runs in ventilation mode | Select the cooling mode(A/C) |
| | The cooling mode has just turned off automatically | Wait about 3-5minutes until the thermostat switches on again |
| Abnormal sounds or vibrations | The mounting brackets are not properly installed on the vehicle, or the device mounting screws are not sufficiently tightened | Check that the mounting bracket is tight and tighten the device mounting screws |
| Water is leaking from the indoor unit | The rubber stopper on the bottom of the indoor unit is missing, or is not pressed enough | Check or replace the rubber stopper |
| | The device is at an angle | The device must be mounted horizontally (maximum angle <3°) |
| The appliance emits a related odor | There is a serious problem | Switch off the device immediately and contact the dealer |

MAINTENANCE

There are no user serviceable parts in this product other than the air filter. Any maintenance must be carried out by a qualified and approved supplier. A service manual is available upon request.

Cleaning the unit

The item must be switched off and disconnected from the mains before cleaning. Wipe the outside with a damp cloth, and then thoroughly dry the equipment with a dry cloth. Do not allow water or harmful substances to enter the machine. Do not use gasoline or other chemicals to clean the unit. Dust and debris can be removed using a soft bristle brush

MAINTENANCE (CONTINUED)

Cleaning the air filter

1. It is important to regularly remove the dust from the filter.
2. Remove the filter as shown in fig. 6
3. Clean the filter with tap water and / or a vacuum cleaner to remove any dirt from the filter.
4. Do not use water hotter than 40°C for cleaning and do not expose the filter to the sun.
5. Make sure the filter has dried before putting it back in the air conditioner.

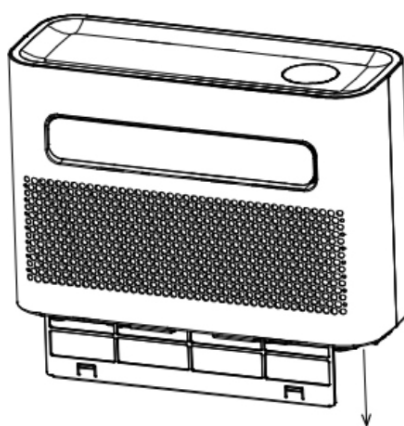

fig. 6



STORAGE

If you are planning to store the machine without needing to use it for a long time, please remove the drain cover from the drainage hole at the bottom of both indoor unit and outdoor unit, and drain all the condensation water appropriately in available place (see fig. 7)

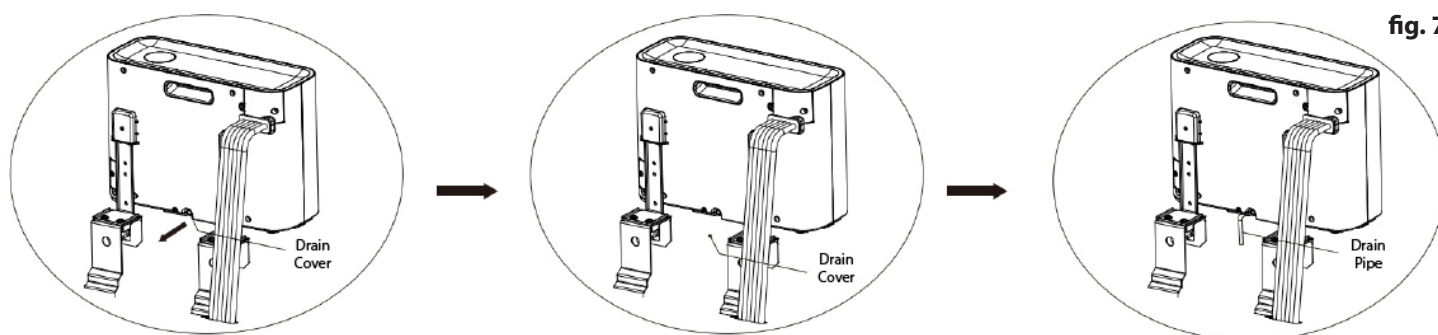
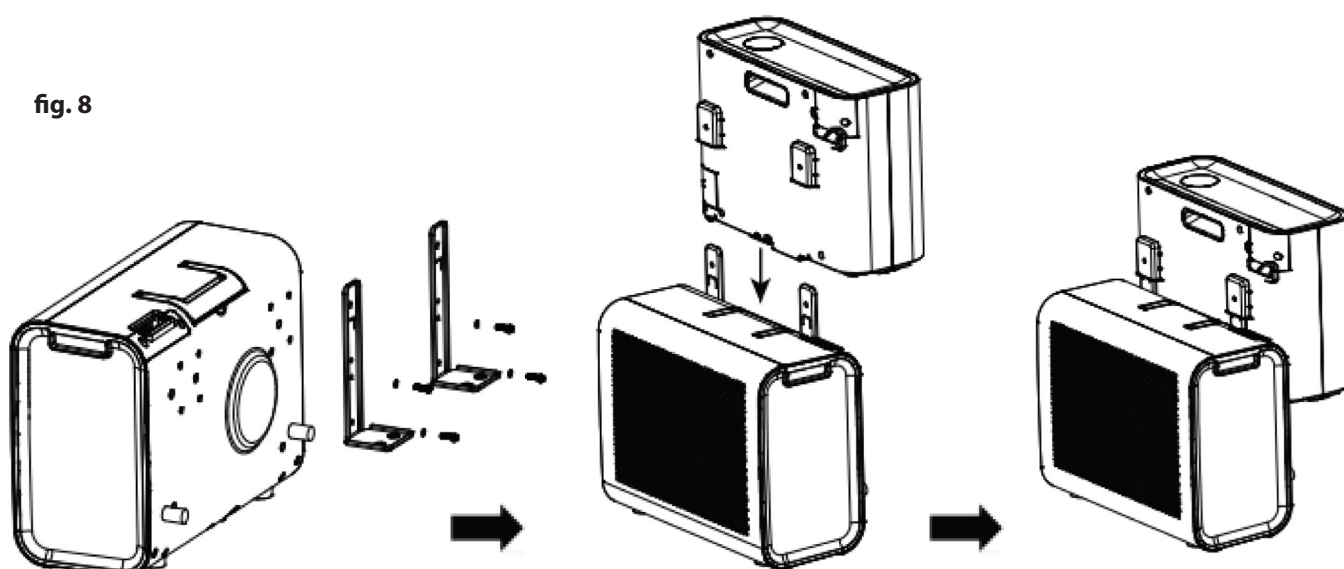

fig. 7

1. Remove the rubber seal of the indoor unit and connect the drainage pipe to drain the condensate into a usable container.
2. Keep running in fan mode to make the internal dry.
3. Turn off the air conditioner and disconnect from the mains.
4. Wash the filter then install.
5. Remove the unit from the window.
6. Remove the rubber seal of the outdoor unit and connect the drainage pipe to drain the condensate into a usable container.
7. Remove all the brackets on the air conditioner, install the brackets of the indoor unit on the outdoor unit, assemble as shown in fig. 8, and then store the unit against the wall.
8. Store the air conditioner in a well-ventilated room of over 4m³.
9. Cover the air conditioner to stop dirt and dust from accruing on the product.

*** Before each change of location or reassembly of the device, ensure that the Water tank emptied.**

fig. 8



TECHNICAL SPECIFICATIONS

| | |
|--|-------------------|
| Voltage | 220~240V 50/60Hz |
| Cooling capacity | 5000btu/h (1465W) |
| Power | 560W |
| Refrigerant | R290, 130g |
| Dimensions inside unit | 455×182×328mm |
| Dimensions outside unit | 460×222×363mm |
| Air flow capacity | 140-200m3/h |
| Dehumidification capacity | 0.5L/h |
| Isolation Class (for outside part) | IP24 |
| Compressor type | Rotor type |
| Sound pressure level (for indoor part) | 46 dB |
| Net weight | 205kg |

R290 (PROPANE) REFRIGERANT SAFETY



System Charge: 130g
Class: A3 - Highly Flammable

Room Size

Minimum 4m² with normal ceiling height

Handling

- Only trained personnel
- Ventilate work area
- Use spark-proof tools & recovery machines
- Do not mix with other refrigerants

Storage

- Keep cylinders in cool, ventilated area
- Away from heat, sparks, sunlight
- Post flammable gas warning signs

Service

- Always have CO₂/dry powder extinguisher nearby
- Leak test with approved methods (no naked flame)
- Switch off power before opening system

Emergency

- **Leak:** Power off, ventilate, remove ignition sources
- **Fire:** Extinguish with CO₂/dry powder/foam; cool cylinders with water spray
- **Exposure:** Move to fresh air, seek medical aid

ENVIRONMENTAL AND DISPOSAL INFORMATION

- This appliance is covered by the Waste Electrical and Electronic Equipment (WEEE) Regulations
- Do not dispose of this appliance with household waste. It must be taken to an appropriate recycling facility
- The refrigerant and compressor oil must be recovered before disposal by an authorised service centre

CONTACT

Prem-i-air Appliances Ltd, Lancots lane, Sutton, St. Helens, WA9 3EX sales@prem-i-air.co.uk



Name: Prem-i-Air Appliances Ltd.

Address: Lancots Lane, Sutton Oak, St. Helens, WA9 3EX

Tel: 01744 745 030 | **E-mail:** sales@prem-i-air.co.uk

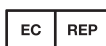

Name: Aidapt B.V.

Address: Algolweg 22, Amersfoort, 3821BH, NL

Tel: +31 0332779210 | **E-mail:** nederland@aidapt.eu

