



G002GP

Professional Fog/Bubble Machine with Remote Control



Instruction Manual

This manual is an integral part of the product and should remain with the unit at all times. If the unit is sold or transferred, this manual must be included.

THIS IS NOT A TOY



BEFORE USE

You must inspect the product including its cable and plug for any signs of damage. If the product is damaged, DO NOT use it, and contact your supplier immediately.

PRODUCT SAFETY

Please read all instructions carefully before use.

Inspect the product, power lead, and all accessories for any signs of damage or wear before each use. If any damage is found, do not use the unit and contact your supplier.

This device is designed solely as an effects machine to generate artificial smoke, mist, and bubbles for entertainment purposes.

SAFETY INSTRUCTIONS

This unit may be operated by:

Individuals aged 14 years and older.

Persons with reduced physical, sensory, or mental capabilities, or limited experience, only if they have received appropriate supervision or instruction on safe operation and understand the potential hazards.

Important:

- Children must not play with the unit.
- Do not use near paint, petrol, or other flammable materials.
- Always switch off and unplug the unit when not in use.
- For domestic use only.

• THIS IS NOT A TOY

Periodically check for damage; discontinue use immediately if damage is detected.

- Never leave the unit unattended while operating.
- Must be used on a flat, stable, and heat-resistant surface.
- No user-serviceable parts inside.
- Do not move or disturb the unit during operation.
- Do not cover or block airflow; allow for proper ventilation.
- Keep away from flammable objects—unit operates at high temperatures.
- Avoid contact with direct heat or flames — RISK OF FIRE.
- Use only as intended. Do not modify or use for other purposes.
- Use only FX-approved fluids.
- Keep out of reach of children and animals.
- Always unplug and allow to cool before moving, cleaning, refilling, or maintenance.
- Not intended for permanent installation.
- Tanks must be filled before use—never operate the machine dry.
- Do not direct bubbles or smoke into people's faces.
- Surfaces may become slippery during prolonged use.
- Indoor use only.
- Maintain 100cm clearance around the unit while operating.
- Do not overfill.
- Do not obstruct the nozzle.
- Do not spray toward open flames or heat sources.
- Do not store or move the unit with liquid in the tanks—fluid can leak into electronics, **CAUSING A FIRE OR ELECTRIC SHOCK RISK.**
- **POSITION BEFORE FILLING:** This unit must be correctly positioned before any fluids are added.
- **COOLING AND DRAINING REQUIRED:** After use, do not move the machine until it has fully cooled down and all fluids have been removed using the procedure detailed later in this manual.
- **HAZARD RISK:** Moving the unit while fluids are present can cause spills and may allow fluids to enter electrical components — **RISK OF ELECTROCUTION AND FIRE.**

DESCRIPTION OF PARTS

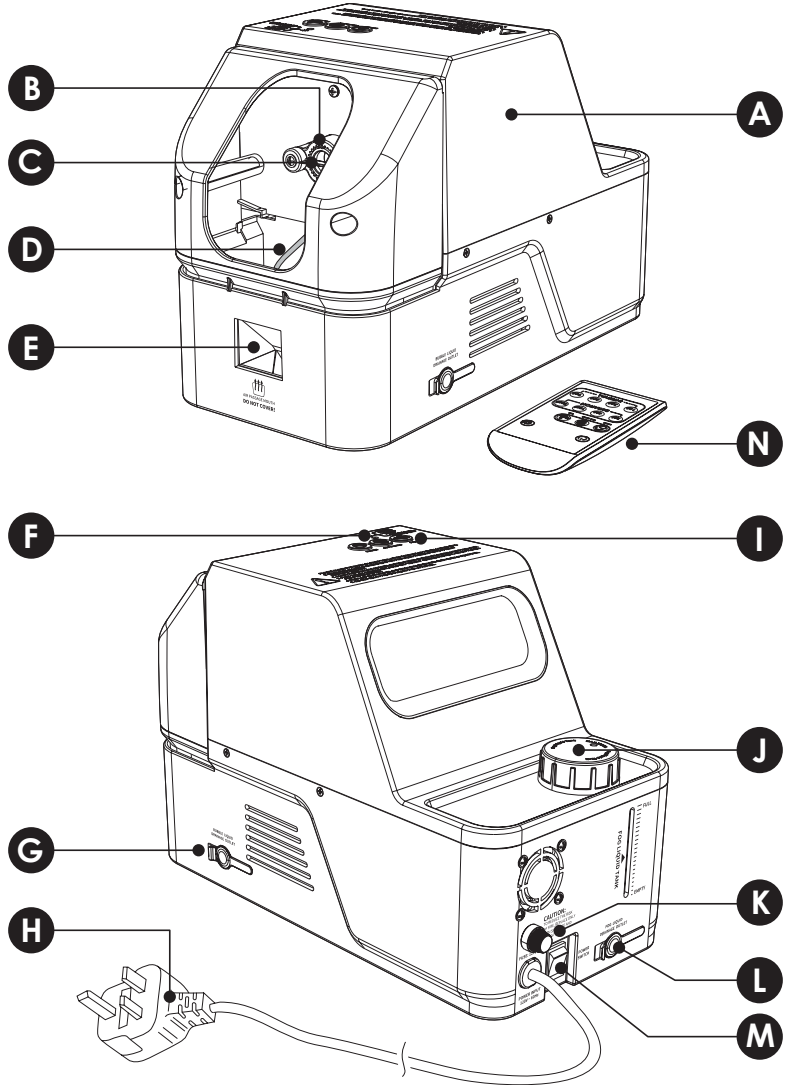

A. Fog Bubble Machine	B. Nozzle	C. Bubble Scraper
D. Tube	E. Air Outlet	F. LED Status Indicator
G. Bubble Liquid Drainage Cap	H. Power Cord	I. Function Button
J. Fog Liquid Tank Cap	K. Fuse	L. Fog Liquid Drainage Cap
M. Power Switch	N. Wireless Remote Control	

OPERATION AND TROUBLESHOOTING

1

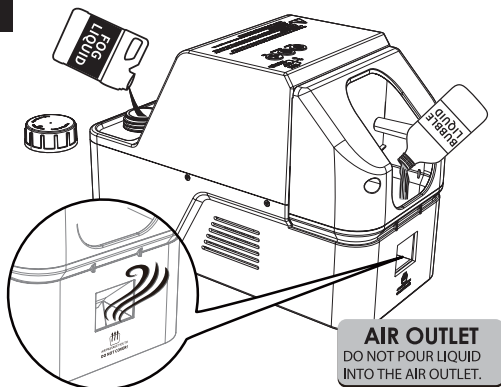

Fill the bubble liquid tank and fog liquid tank
DO NOT EXCEED their maximum fill lines.
DO NOT pour liquid into the air outlet.

NOTE:

Only fill the tanks with the specified fluid to prevent damage or malfunction

Always disconnect the machine from the mains power supply before filling or emptying its contents.

2

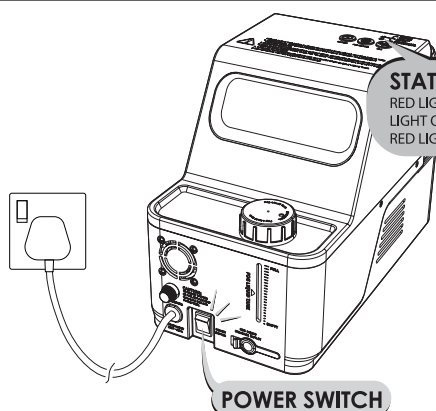

STATUS INDICATOR

RED LIGHT - Warm-up time.
LIGHT OFF - Ready for fog bubbles and fog.
RED LIGHT FLASH - No Fog Liquid

Plug the power cord (H) into a power outlet and switch on the power (M). The LED status light (F) will illuminate. After 3–5 minutes, the machine will be heated, and the LED status light will turn off. The machine is now ready for use.

3

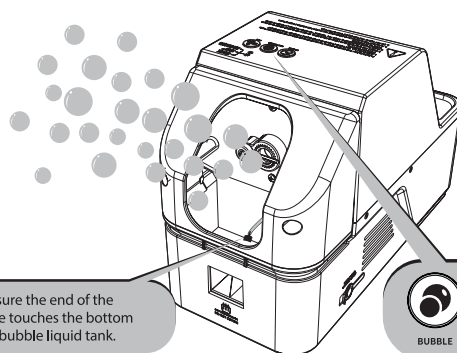

Push the (I) Function Button or the (N) Wireless Remote Control to activate the different working modes as you want.

BUBBLE - make the regular colorful bubbles

FOG BUBBLE - create white fog filled bubbles

FOG - produce the continuous fog



BUBBLE



FOG BUBBLE



FOG

REMOTE CONTROL USAGE

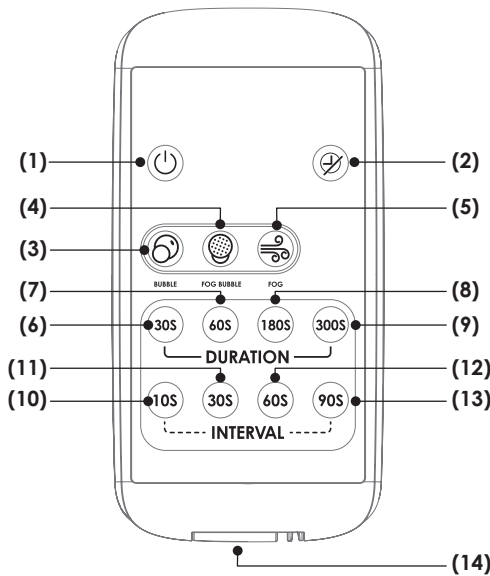

- (1) ON/OFF
- (2) Timer Off
- (3) Only Bubbles
- (4) Fog Bubbles
- (5) Only Fog
- (6) 30 Seconds Working
- (7) 60 Seconds Working
- (8) 180 Seconds Working
- (9) 300 Seconds Working
- (10) 10 Seconds Interval
- (11) 30 Seconds Interval
- (12) 60 Seconds Interval
- (13) 90 Seconds Interval
- (14) Battery Compartment

Timer Settings: e.g., push the button “30S” of DURATION section and the button “10S” of INTERVAL section, this machine will run 30 seconds in current working mode, then pause 10 seconds, repeat this cycle. Push the button “Timer Off” to cancel the timer settings.

CAUTION

- 1. Timer settings should be finished within 10 seconds, otherwise the function of timer on the remote control will not work.
- 2. One remote control can operate multiple bubble fog machines at the same time in the wireless signal range.
- 3. Maximum remote control distance is about 40 feet (12 meters).

! WARNING

- **INGESTION HAZARD:** This product contains a button cell or coin battery
- **DEATH** or serious injury can occur if ingested.
- A swallowed button cell or coin battery can cause Internal Chemical Burns in as little as 2 hours.
- **KEEP** new and used batteries **OUT OF REACH** of **CHILDREN**
- Seek immediate medical attention if a battery is suspected to be swallowed or inserted inside any part of the body.



AFTER EACH USE

Always ensure the unit is cool and unplugged before cleaning.

1. After each use, empty and clean the bubble tank.
2. Drain both bubble liquid and fog fluid using the designated outlets.
3. Close drainage outlets, then pour 300ml of distilled water into the bubble tank only.
4. Activate the machine and press the “Bubble” function button. Let it run for 5–10 minutes.
5. Switch off the unit and unplug it again.
6. Empty the distilled water and replace all drainage stoppers securely.

MAINTENANCE & STORAGE

Always unplug and allow the machine to cool before performing maintenance.

Drain all fluids prior to storage.

Store in a cool, dry place, away from direct sunlight.

Clean only with a slightly damp cloth—do not use strong cleaning agents or detergents.

Avoid any exposure to moisture or heat during storage.

SPECIFICATIONS

Size	326x166x230mm
Input Voltage	230Vac@50Hz
Output Current	5A
Power Rating	450W
Working Temperature	5-45 deg C
Fog Tank Capacity	310ml
Bubble Tank Capacity	550ml
Fuse	250V 5A
Remote Control Battery	1 x CR2032 (not supplied)



Name: Electrovision Ltd.

Address: Lancots Lane,
Sutton Oak, St. Helens,
WA9 3EX

Tel: 01744 745 000

E-mail: sales@electrovision.co.uk



Name: Aidapt B.V.

Address: Algolweg 22,
Amersfoort, 3821BH, NL

Tel: +31 0332779210

E-mail: nederland@aidapt.eu