



365
DAYS
LIGHT

SMART TECHNOLOGY!

10 LUMEN

This label features a dark blue background with a light green circular graphic on the left containing the text '365 DAYS' and a blue arrow pointing right with the word 'LIGHT' written inside it. To the right of this graphic is the text 'SMART TECHNOLOGY!' in a white, italicized font. Further right, the number '10' is displayed in a large, bold, blue font, followed by the word 'LUMEN' in a smaller, blue, sans-serif font. The entire label is enclosed in a rounded rectangular shape with a pink border.

365
DAYS
LIGHT

SMART TECHNOLOGY!

RoHS ✓
WEEE COMPLIANT

8 719099 230091

This label features a dark blue background with a light green circular graphic on the left containing the text '365 DAYS' and a blue arrow pointing right with the word 'LIGHT' written inside it. To the right of this graphic is the text 'SMART TECHNOLOGY!' in a white, italicized font. Further right, there is a white rectangular area containing a barcode and the number '8 719099 230091' below it. Above the barcode is a 'RoHS' logo with a checkmark and the text 'WEEE COMPLIANT' below it. The entire label is enclosed in a rounded rectangular shape with a pink border.



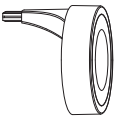

Orange

Art.nr. 23009
LB23009

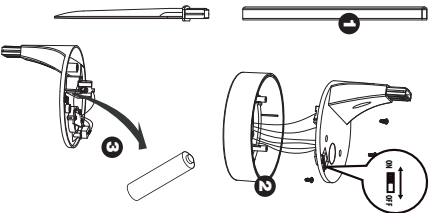

LUXFORM
LIGHTING

Luxform Global BV
Transportstraat 1
8263 BW Kampen
The Netherlands
Go to: www.luxform.eu

1.2V
MINI-LED
AA-600MAH

P8

4x
3x UP
1x DOWN
SOFTONE LED
L15

6H

P11

F
M2



C7



M5



C1



M18



C9



M19

LED

L13

CE

